

AJPL V2 Multi Watt Multi CCT Backlit Panel Series Installation Guide

SAFETY INSTRUCTIONS: Read instructions carefully before attempting to install fixture.

- Fixture must be wired in accordance with the National Electrical Code and all applicable local codes.
- Proper grounding is required for safety.
- This product must be installed in accordance with the applicable installations code by a person familiar with the construction and operation of the product and the hazards involved.
- This fixture complies with Part 15 of FCC rules. Operation is subject to the following two conditions:
 - 1) This fixture may not cause harmful interference.
 - 2) This fixture must accept any interference received, including interference that may cause undesired operation.

CAUTION: Risk of fire

- **WARNING:** Space for adjustment cannot be more than 1/8" (33mm) or the fixture will fall. Confirm that the ceiling can support the weight of the fixture. The fixture must be fully recessed into the grid.
- **WARNING:** NOT suitable for use in wet locations.
- **WARNING:** Do NOT handle energized fixture when hands are wet, when standing on wet or damp surfaces or in water.
- **WARNING:** Vapor barrier must be suitable for 90°C.
- **WARNING:** Fixture to be independently supported to building structure.
- **WARNING:** Class I wiring for dimming wire.

CLEANING & MAINTENANCE:

CAUTION: Be sure the fixture temperature is cool enough to touch. Do NOT clean or maintain while the fixture is energized.

1. Clean fixture with non-abrasive cleaning solution.
2. Do NOT open fixture to clean the LEDs. Do NOT touch the LEDs.

Note: These instructions do not cover all details or variation in equipment, nor do they provide for every possible situation during installation, operation or maintenance.

WIRING INSTRUCTIONS:

Universal voltage driver permits operation at 120V through 277V. (See images on page 2)

1. Connect the **Black** fixture lead to the **LINE** supply lead.
2. Connect the **White** fixture lead to the **COMMON** supply lead.
3. Connect the **Green** wire from fixture to **supply ground**.
4. Connect the **Purple** wire to the **DIM+**.
5. Connect the **Pink** wire to the **DIM-**.

TROUBLESHOOTING:

1. Check that the LINE voltage at fixture is correct. Refer to the wiring directions.
2. Is the fixture grounded properly?

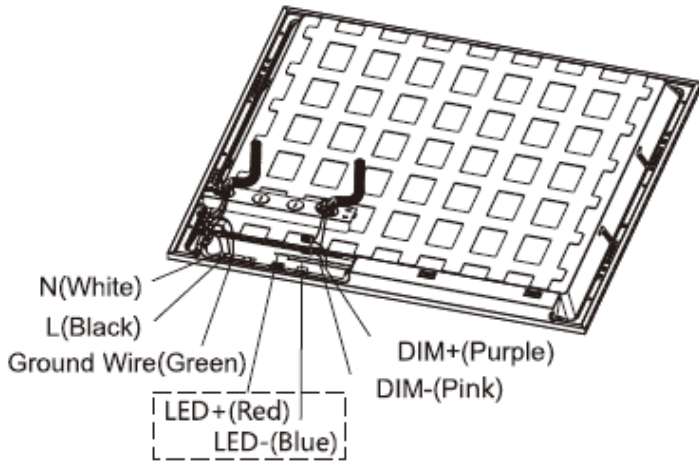

Basic version

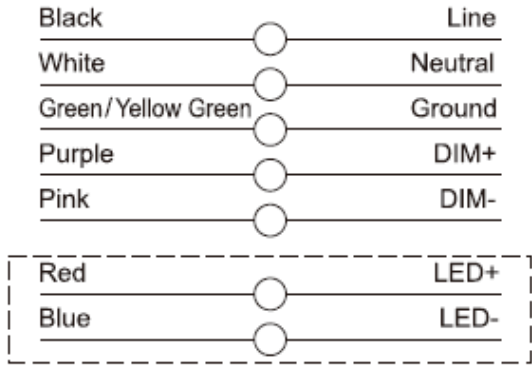

Optional
⇒ Use only in
Emergency Mode

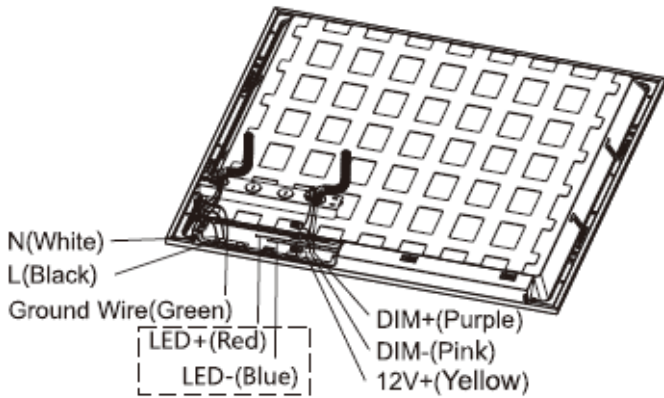

Sensor version

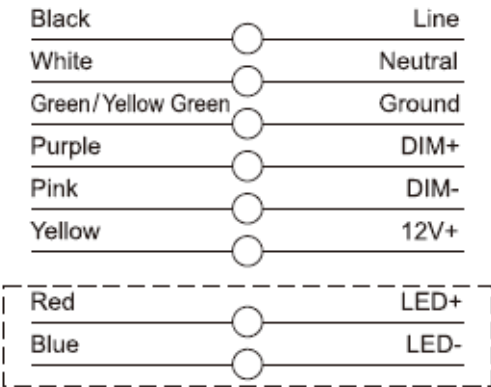

Optional
⇒ Use only in
Emergency Mode

RECESSED CEILING MOUNTING:

The fixture is suitable only for INDOOR RECESSED CEILING application.

Above ceiling access required.

WARNING: Space for adjustment cannot be more than 1/8" (33mm) or the fixture will fall.

1. Unscrew the driver cover and connect the conduit to the driver box.
2. Select the desired wattage and color temperature by using the toggle switches located on the back of the fixture.
3. Connect wires as shown in wiring diagram. Push all wires back into the box. Use appropriate UL/ETL-approved wire connectors as required by code to complete wiring. Be careful not to pinch wires. **WARNING:** To prevent wiring damage or abrasion do not expose wiring to edges of sheet metal or other sharp objects.
4. Firmly bend the pre-installed grid clips. Secure the fixture to the see T-Grid bar.
5. Support wires may be required by installation codes. Support the fixture to the building structure with support wires (supplied by others) through the grid clip hole.
6. Make sure that the orientation of the splice box and access plate faces an accessible tile to make electrical splices.
7. Loosen access plate screw and remove the access plate knock out appropriate conduit knockouts on the access plate to route input conduit. Use appropriate conduit connectors as required by code.
8. Replace the cover and tighten the screws.

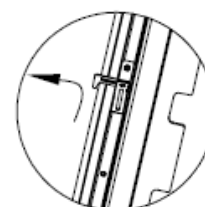
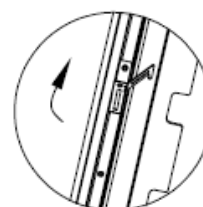
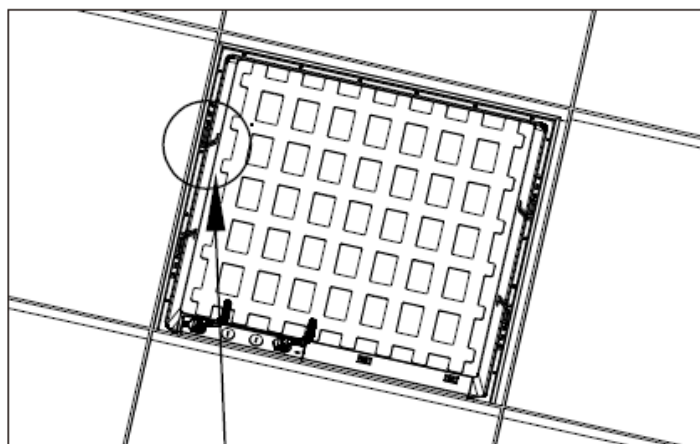
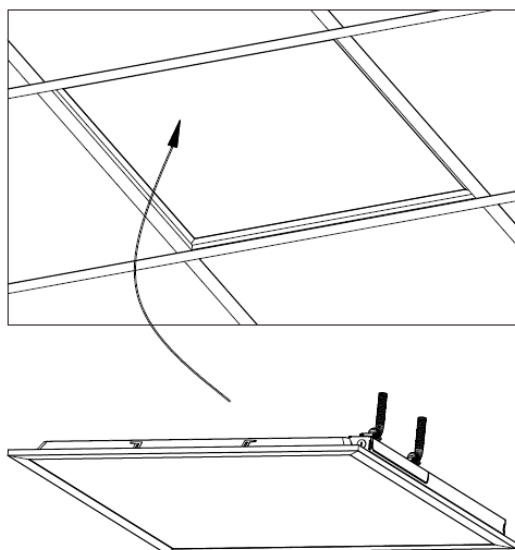
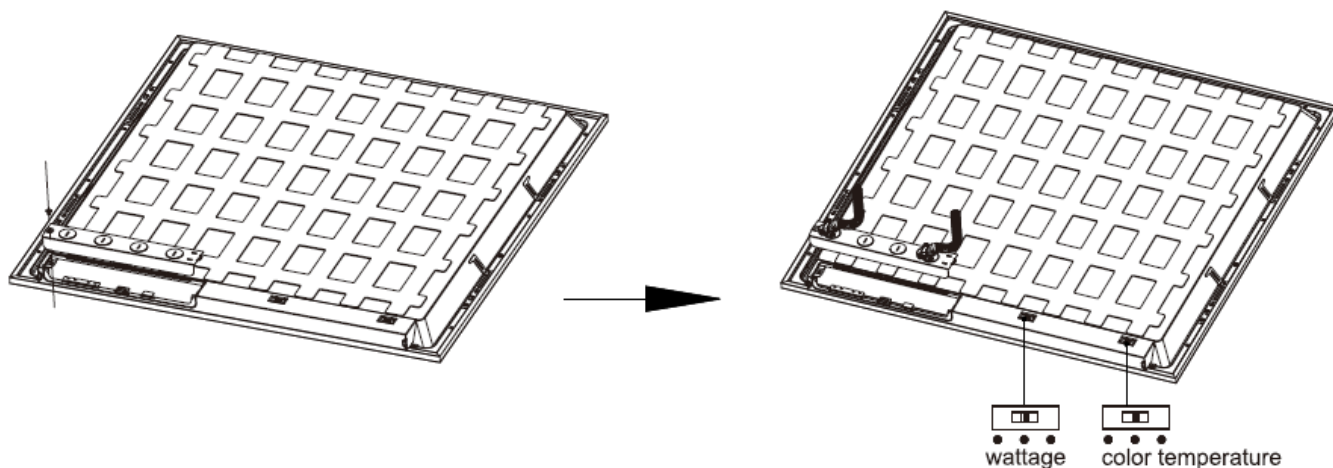

WATTAGE AND CCT ADJUSTABLE TABLE SWITCH SETTING:

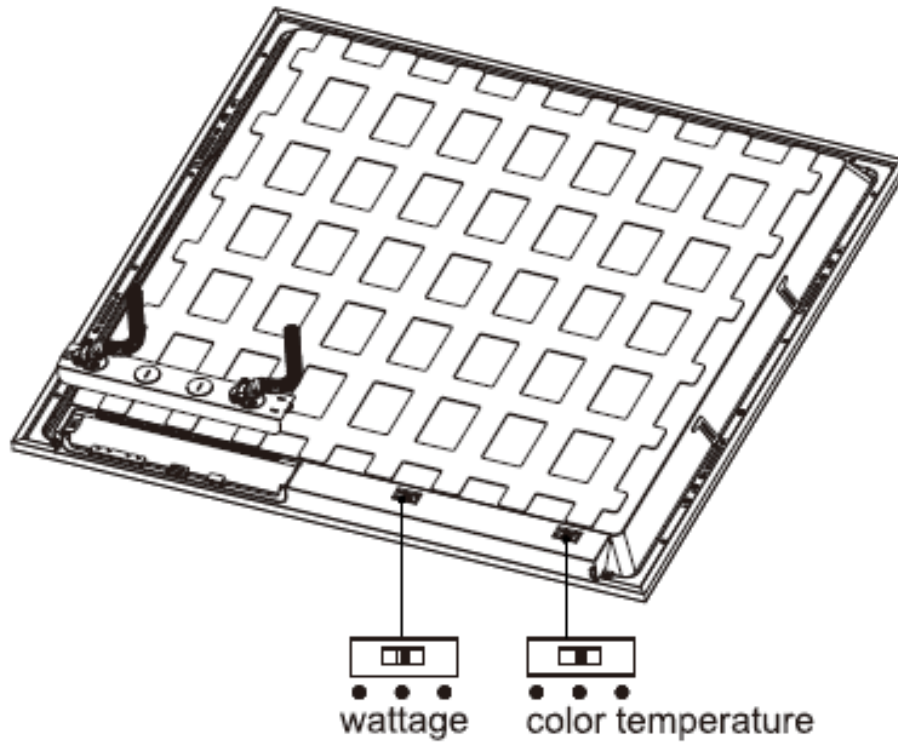

1x4

Default Wattage: 30W

Default CCT: 5,000K

Wattage Options: 20W / 25W / 30W

CCT Options: 3,500K / 4,000K / 5,000K

2x2

Default Wattage: 30W

Default CCT: 5,000K

Wattage Options: 20W / 25W / 30W

CCT Options: 3,500K / 4,000K / 5,000K

2x4

Default Wattage: 40W

Default CCT: 5,000K

Wattage Options: 30W / 35W / 40W

CCT Options: 3,500K / 4,000K / 5,000K

OR

2x4

Default Wattage: 50W

Default CCT: 5,000K

Wattage Options: 30W / 40W / 50W

CCT Options: 3,500K / 4,000K / 5,000K